

# THREE COUNTERBALANCE MONITOR ARM

[www.ctfconsoles.com](http://www.ctfconsoles.com)

# CTF-MA-03

The **CTF-MA-03** is a premium counterbalance monitor arm with a durable gas spring aluminum design, compatible with most 17" to 27" flat and curved monitors.

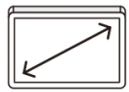

Screen Size  
**17"-27"**

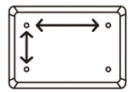

VESA Compatible  
**75x75 100x100**



Weight Capacity  
**1.5-7kg (x3)**



Tilt Range  
**+45° ~ -45°**

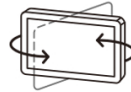

Swivel Range  
**+90° ~ -90°**



Screen Rotation  
**+180° ~ -180°**

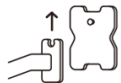

Detachable  
VESA Plate



Cable  
Management



Curved Monitor



Clamp & Grommet  
Installation

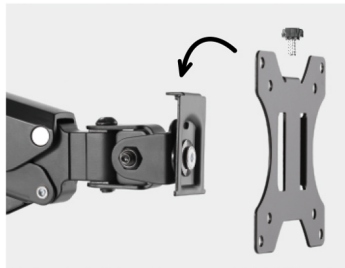
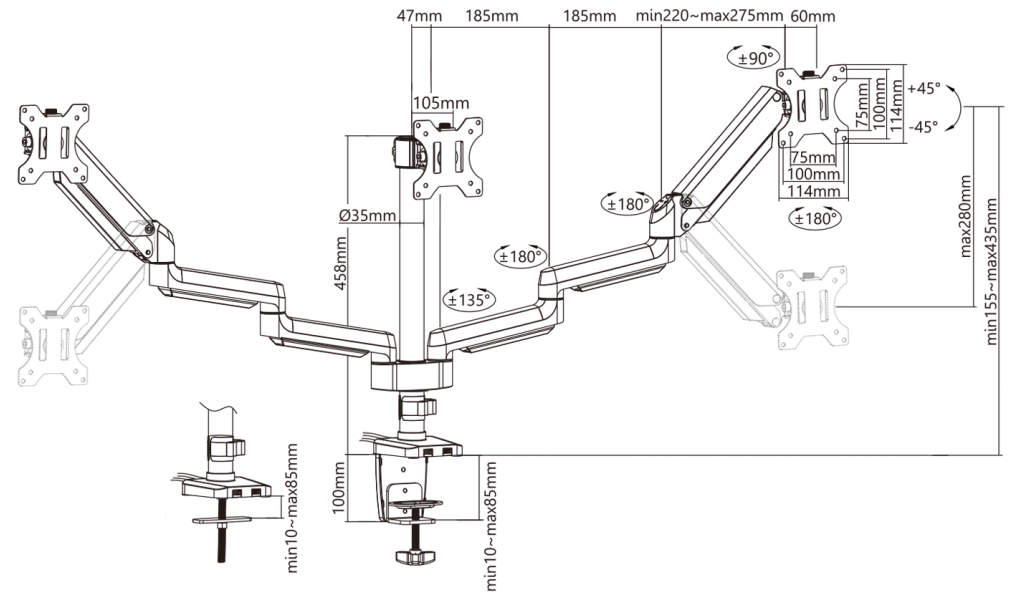

**Detachable VESA Panel**  
makes installations quick easy.



**Adjustable Gas Spring Tension**  
able to bear most types of monitor

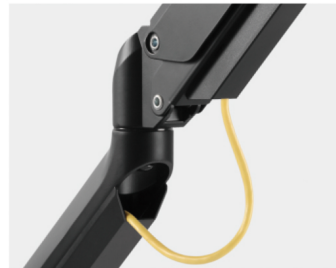

**Built-in Cable Management**  
create a clean look by eliminating cable clutter.



**Clamp & Grommet Installation**  
accommodate more users.





**CONNECTED TECHNICAL FURNITURE**

**CTF Metal Steel Workshop LLC**

Warehouse B3, Dubai Investment Park-1, Dubai, United Arab Emirates

 [www.ctfconsoles.com](http://www.ctfconsoles.com)

 [CTF Consoles](#)

 [hello@ctfconsoles.com](mailto:hello@ctfconsoles.com)